

REQUEST FOR QUOTE # 44-159D-2012

ABATEMENT/DEMOLITION SERVICES



By:
Charlene McNair, Buyer II
Riverside County Transportation and Land Management
4080 Lemon Street, 14th Floor
Riverside, CA 92502
(951) 955-1858 / (951) 955-1859 (fax)
Email: CMcNair@rctlma.org

INSTRUCTIONS TO BIDDERS

- I. **Vendor Registration** – Unless stated elsewhere in this document, vendor must register online at www.Purchasing.co.riverside.ca.us with all current Vendor information, to be registered on the County’s database.
- II. **Prices/Notations** - All prices/notations must be typewritten or written in ink. No erasures permitted. Mistakes shall be crossed out, corrections made adjacent and initialed by person signing document. Each item shall be bid separately.
- III. **Format** - Use the documents provided. If submitting more than one bid, separate the bid documents.
- IV. **Pricing/Delivery Terms/Tax** - All pricing shall be quoted F.O.B. destination, (e.g., cash terms less than 20 days should be considered net) excluding applicable tax. The County reserves the right to designate method of freight. The County pays California Sales Tax and is exempt from Federal excise tax. In the event of an extension error, the unit price shall prevail.
- V. **Other Terms and Conditions** - The terms and conditions as indicated in this document and/or attached are hereby included with full force and like effect as if set forth herein. Copies of the applicable Terms and Conditions may be obtained by contacting Riverside County Purchasing at the number shown above and requesting a copy be faxed or mailed to you.
- VI. **Period of Firm Pricing** - Unless stated otherwise elsewhere in this document, prices shall be firm for 90 days after the closing date.
- VII. **Specification/Changes** - Wherever brand names are used, the words "or equal" shall be considered to appear and be a part of the specification. If you are quoting another make or model, cross out our nomenclature and insert yours. If no make or model is stipulated, insert yours. Attach applicable specifications and/or brochures. Variations in manufacturers, design, etc., may be acceptable, bidders are encouraged to offer them as alternatives; however, the County reserves the right to reject those alternatives as non-responsive.
- VIII. **Recycled Material** - Wherever possible, the County of Riverside is looking for items made from, or containing in part, recycled material. Bidders are encouraged to bid items containing recycled material as an alternative for the items specified; however, the County reserves the right to reject those alternatives as non-responsive.
- IX. **Environmental Requirements**
- X. **Method of Award** - The County reserves the right to reject any or all offers, to waive any discrepancy or technicality and to split or make the award in any manner determined by the County to be most advantageous to the County. The County recognizes that prices are only one of several criteria to be used in judging an offer and the County is not legally bound to accept the lowest offer.
- XI. **Return of Bid/Closing Date/Return to** - The bid response shall be delivered to the address above or may also FAX'ed to the dedicated Secure Bid FAX number listed above by 1:30 p.m. on the closing date listed above. Bid responses not received by County Purchasing by the closing date and time indicated above will not be accepted. The closing date and time and the RFQ number referenced above shall appear on the outside of the sealed envelope or on the FAX cover sheet. A duly executed copy of the signature page of this bid document must accompany your response. The County will not be responsible for and will not except late bids due to busy FAX lines, incomplete transmissions or delayed mail delivery or courier services.
- XI.I **Local Preference** - The County of Riverside has adopted a local preference program for those bidders located within the County of Riverside. A five percent (5%) price preference may be applied to the total bid price during evaluation of the bid responses. To qualify as a local business, the business must have fixed offices within the geographical boundaries of Riverside County and must credit all sales taxes paid resulting from this RFQ to that Riverside County location.
or
- XIII. **Disabled Veteran Business Enterprise Preference** - The County of Riverside has implemented a Disabled Veteran Owned Business preference policy. A three percent (3%) preference shall be applied to the total bid price of all quotes/bids/proposals received by the County from certified disabled veterans owned businesses. If the bid is submitted by a non-Disabled Veteran owned business, but lists subcontractors that are identified and qualified as Disabled Owned Business, the total bid price will be adjusted by 3% of the value of that subcontractor’s portion of the bid

IF CHECKED, THE FOLLOWING DOCUMENTS HEREBY MADE PART OF THIS RFQ

- | | | | |
|---|---|-----------------------------------|-----------------------------|
| <input checked="" type="checkbox"/> APPENDIXS "A"
<input type="checkbox"/> SAMPLES | <input checked="" type="checkbox"/> PLANS/DRAWINGS/PHOTOS/ASBESTOS REPORT/MAP
<input checked="" type="checkbox"/> EXHIBITS | | |
| <input type="checkbox"/> #116-110 | Special Conditions/Response | <input type="checkbox"/> #116-150 | Special Conditions |
| <input type="checkbox"/> #116-140 | Special Conditions Personal/Professional Services | <input type="checkbox"/> #116-130 | Equipment Information Sheet |
| <input checked="" type="checkbox"/> #116-260 | Local Business Qualification Affidavit | <input type="checkbox"/> #116-310 | Boilerplate Contract |

IF CHECKED, THE FOLLOWING GENERAL CONDITIONS ARE INCLUDED WITH FULL FORCE AND LIKE EFFECT AS IF SET FORTH HEREIN

- | | | | |
|--|--|-----------------------------------|--|
| <input checked="" type="checkbox"/> #116-200 | General Conditions | <input type="checkbox"/> #116-210 | General Conditions Materials and/or Services |
| <input type="checkbox"/> #116-230 | General Conditions - Equipment | <input type="checkbox"/> #116-220 | General Conditions - Public Works |
| <input checked="" type="checkbox"/> #116-240 | General Conditions - Personal/Professional Service | | |

To access any of these General Conditions go to www.purchasing.co.riverside.ca.us, located in Vendor Registration/Bidding Opportunities.

APPENDIX A

1.0 PURPOSE/BACKGROUND

The County of Riverside TLMA on behalf of Code Enforcement is soliciting quotations to provide all labor and equipment for the abatement per the scope of work as detailed on page #9 of this RFQ.

CONTRACTOR'S REQUIREMENTS

Contractor and/or Sub-contractors must possess the proper Contractors license (see section 4.0) issued by the State of California for each craft or type of workman or mechanic needed to execute the contract. Upon request, provide to the TLMA Purchasing a certificate of liability insurance form listing "the County of Riverside: as additional insured and proof of Worker's Compensation Insurance for his employees. Contractor will be required to list all hazardous waste fees for California and all Out of State Fees. Contractor must comply with all State and Federal regulations on the proper disposal of all non hazardous waste materials. The Contractor will notify the County of Riverside in advance of all hazardous materials being transported and the location of the disposal site.

2.0 TIMELINE

DATES:

1. RELEASE OF REQUEST FOR QUOTATION	May 12 th , 2011
3. MANDATORY JOB WALK	June 8 th , 2011 At 10:30 AM
4. DEADLINE FOR QUOTATION SUBMITTAL	June 10 th , 2011 At 1:30 PM
5. TENTATIVE DATE FOR AWARDED CONTRACT	To Be Determined

3.0 GENERAL REQUIREMENTS

Procedures for Submitting Quotations

All quotations must be submitted in accordance with the standards and specifications contained within this Request for Quote (RFQ).

The County reserves the right to waive, at its discretion, any irregularity, which the County deems reasonably correctable or otherwise not warranting rejection of the quotation.

The County shall not pay any costs incurred or associated in the preparation of this or any quotation or for participation in the procurement process.

Quotes must be specific unto themselves. For example, "See Enclosed Manual" will not be considered an acceptable quotation. Receipt of all addenda, if any, must be acknowledged in the quotation.

Late quotations will not be accepted. Postmarks **will not** be accepted in lieu of this requirement. Quotations submitted to any other County office will be rejected.

4.0 SPECIAL INSTRUCTIONS/REQUIREMENTS

1. Contractor needs to schedule and coordinate work throughout the job with Code Enforcement, Regina Keyes @ 951-485-5840.
2. High probability that a Warrant will be needed for the abatement of this property. Items can only be removed after a seizure warrant has been obtained by Code Enforcement if applicable. All work to be in conformance with Seizure Warrant within dates specified and start/end dates.
NOTE: EQUIPMENT CANNOT BE STORED ON THE PROPERTY.
3. All work to be in conformance to applicable codes and in compliance with Rule 1403 of the South Coast Air Quality Management District (SCAQMD) regarding requirements pertaining to the demolition of asbestos containing waste material. **Contractor must provide a copy of their Asbestos handling license to TLMA Purchasing before work begins. Copies of dump receipts will be required at the end of the job and must be attached to the invoice when submitting for payment.**
4. JOINT VENTURES ARE PERMISSABLE. HOWEVER, THE COUNTY WILL CONTRACT WITH THE PRIMARY CONTRACTOR WHO WILL ASSUME LIABILITY FOR ALL WORK PERFORMED BY THE SUB-CONTRACTOR. THE AWARDED CONTRACTOR WILL BE SOLELY RESPONSIBLE FOR IDENTIFYING ANY SUB-CONTRACTOR USED ON THE JOB.

IN A JOINT VENTURE, BOTH THE CONTRACTOR AND SUB-CONTRACTOR MUST HAVE THE APPROPRIATE LICENSING AND CERTIFICATION.

EACH CONTRACTOR MUST INDICATE THEIR ABILITY TO SECURE THE NECESSARY INSURANCE. CONTRACTOR MUST PROVIDE CURRENT COPY OF INSURANCES PRIOR TO STARTING WORK.

The County of Riverside has adopted a Local Preference Program for those bidders located within the County of Riverside. A five (5) percent price preference may be applied to the total bid amount during the evaluation of the bid response.

5. PERMIT LIMITATIONS AND DEMOLITION REQUIREMENTS

By authority contained in Section 303.4 of the Uniform Administrative Code under Riverside County Ordinance 457, every demolition permit issued shall have an implied time limitation of 45 days. All work pertinent to demolition prescribed by Riverside County Ordinances 457 and 348 shall be fulfilled within this allocated time interval.

DESCRIPTION, SCOPE, AND NATURE OF WORK RELEVANT TO EACH PARTICULAR DEMOLITION SITE IS AS FOLLOWS:

1. Completely demolish each structure.
2. Remove foundations.
3. Remove all debris and residue
4. Dispose of debris and trash created during the demolition process by transporting to an approved land fill
5. Cap sewer within five (5) feet of the property line.
6. Obligation and responsibility for determining the location of any or all abandoned wells, shafts, openings, septic tanks, cesspools, basements, pits or other like hazards lies with the property owner or contractor. All such hazards shall be abated as per Section 722.0, Uniform Plumbing Code, or by methods approved by the Building Official.
7. Burying, covering, or otherwise discarding of debris on the demolition site is a violation of Riverside County Ordinance 348.
8. In instances regarding excavation and removal of service station storage tanks, or other excavations such as swimming pools where substantial backfill is involved, a compaction report by an approved agency shall be filed with the Building Department.
9. Notify all utility companies to remove and/or disconnect all utilities to the structure including all buried pipes, wires, and conduits).
10. Two Inspections Shall Be Called For:
 - a. At the time of abatement of all hazards specified under Instruction No. 6, the operation is to be verified by a Building Inspector.
 - b. Smooth and level site, and call for final inspection.
11. Obtain an Asbestos Clearance from an approved consultant prior to demolition.

6. **OTHER INFORMATION:**

- a. All items or materials removed from the property by the Contractor, his employees or representatives shall be destroyed unless salvaged.
- b.
- c. All salvaged items shall be itemized in a list presented to the County. The value of the salvaged items shall offset the cost charged to the County for the abatement
- d. In the event the offset amount exceeds the cost charged to the County for abatement, the difference shall be refunded to the County to be credited to the property.
- e. If applicable, Contractor must have C-21 License-Building Moving/Demolition Contractor. Sections Cited: 7008 and 7059, Reference: Sections 7058 and 7059 (Business & Professional Code).
- f. If applicable, Contractors must comply with Waste Tire Hauler Regulation and Public Resource Code Section 42954 and IWMB. **Contractor must provide a copy of the TPID number to TLMA Purchasing before work can begin. Copies of dump receipts will be required at the end of the job and must be attached to the invoice when submitting for payment.**
- g. **Hazardous Material: Contractor must provide a copy of their Hazardous material handling license to TLMA Purchasing before work begins. Contractors must comply with Hazardous Material Regulations. Copies of dump receipts will be required at the end of the job and must be attached to the invoice when submitting for payment.**

- h. Dust Control: If applicable, dust control must comply with Riverside County Ordinance 742. For the Coachella Valley, dust control mitigation must be in accordance with CVAG PM10 handbook. BMP's for any construction project are applicable for demolition.
- i. **At the completion of the job the Contractor will be responsible for completing the attached (Exhibit B) form and is responsible for obtaining the signature of a Code Enforcement officer who will verify that the job has been completed to the satisfaction of the County of Riverside and to the Scope of Work outlined in the Request for Quote. A copy of this completed form MUST be attached to your invoice when you submit for payment.**

7. PREVAILING WAGE:

Pursuant to the labor code, the governing board of the owner has obtained from the director of the Department of Industrial Relations, State of California, his/her determination of general prevailing rates of per diem wages applicable to the work, and for holiday and overtime work, including employer payments for health and welfare, pension, vacation, and similar purposes, as set forth on the schedule which is on file at the principal office of the Owner, and which will be made available to any interested person upon request.

- A. Contractor's Requirements: The awarded Contractor will be required to pay their employees the general prevailing rate of wages for each craft or type of workman or mechanic needed to execute the contract, and must adhere to the following:
 - a. Contractor and/or Sub-contractors must possess the proper Contractors license issued by the State of California for each craft or type of workman or mechanic needed to execute the contract.
 - b. Upon request, provide the Purchasing Department a certificate of liability insurance form listing "the County of Riverside" as additional insured and proof of Worker's Compensation Insurance for his employees.
 - c. Pay his/her employees the general prevailing rate of wages for each craft or type of workman or mechanic needed to execute the contract.
 - d. Submit certified payroll per form DLSE Form A-1-131 available at: <http://www.dir.ca.gov/dlse/DLSEFormA-1-131.pdf> (See attached Exhibit A- Public Works Payroll Reporting Form and Notice to Public Entity)

5.0 METHOD OF AWARD

The project will be awarded based on the lowest total cost to the County and overall responsiveness and general understanding of RFQ requirements.

All responses must be received by June 10th, 2011 by 1:30 PM, at the following address:

COUNTY OF RIVERSIDE-TLMA PURCHASING
4080 Lemon Street, 14th Floor
Riverside, CA 92502

Please complete and return pages 3, 10 and 11 of this bid packet.
Faxed bids will be accepted and must be received by the deadline.
Late bids will not be accepted.
Bids can be faxed to 951-955-1859, attention Charlene McNair.

6.0 EVALUATION PROCESS

All quotations will be given thorough review. All contacts during the review selection phase will be only through the TLMA Purchasing Department. Attempts by the BIDDER to contact any other County representative may result in disqualification of the BIDDER.

7.0 CANCELLATION OF PROCUREMENT PROCESS

The County may cancel the procurement process at any time. All quotations become the property of the County. All information submitted in the quotation becomes "public record" as defined by the State of California upon completion of the procurement process. If any proprietary information is contained in or attached to the quote, it must be clearly identified by the BIDDER, otherwise the BIDDER agrees that any and all documents provided may be released to the public after bid award.

The County reserves the right to withdraw the Request for Quote (RFQ), to reject a specific quote for noncompliance within the RFQ provisions, or not award a bid at any time because of unforeseen circumstances or if it is determined to be in the best interest of the County.

8.0 COMPENSATION

The COUNTY shall pay the AWARDED BIDDER for equipment and services performed, after the equipment are installed and tested to the satisfaction of the COUNTY. Expenses incurred and compensation shall be paid in accordance with an invoice submitted to COUNTY by AWARDED BIDDER. The COUNTY shall pay the acceptable invoice within thirty (30) working days from the date of receipt of the invoice, or the goods/services are received, whichever is later.

9.0 SCOPE OF WORK

Contractor to secure appropriate permits and provide all labor and equipment for the demolition of a substandard structure (barn/workshop) and the removal & proper disposal of all rubbish & debris associated with the demolition from the property located below: (Approx. 30 X 40 square feet)

Property Address/Location:
21665 Eucalyptus Lane, Perris, CA

APN: 325-060-013 Case No: CV10-00386

MANDATORY JOB WALK: June 8th, 2011 @ 10:30 AM
MEETING LOCATION:
21665 EUCALYPTUS LANE, PERRIS, CA

IF YOU DO NOT ATTEND THE MANDATORY JOB WALK, YOU CANNOT SUBMIT A BID

APPENDIX A

COST PROPOSAL

PROPERTY ADDRESS

21665 Eucalyptus Lane
Perris, CA
APN: 325-060-013
Case No: CV10-00386

SERVICE

Demolition of
Substandard Structure _____

Removal/Disposal of
Rubbish/Trash/Debris _____

Removal/Disposal of
Asbestos
(if applicable) _____

Removal/Disposal
Of Hazardous Waste
(if applicable) _____

Removal/Disposal
Of Tires
(if applicable) _____

Other (if applicable)

TOTAL: _____

NOTE: Mark N/A if non-applicable, and INCLUDED for items included in the total cost.

COMPANY NAME: _____ DATE: _____
(Print)

REPRESENTATIVE: _____ SIGNATURE: _____
(Print Name)

PROMPT PAYMENT DISCOUNT: _____

Bid must be complete and signed by the company's Authorized Agent.

Local Business Qualification Affidavit

The County of Riverside Local Business Preference may be applied to this Request for Proposal/Quotation. If you qualify for this preference, please submit this form along with your response to this RFP/Q.

Definition of Local Business

A local business shall mean business firms with fixed offices located within the geographical boundaries of Riverside County, authorized to perform business within the County, and in doing so, credit all sales tax from sales generated within Riverside County to the County, and who provide product or perform contracted work using employees, of whom the majority are physically located in said local offices.

Local businesses" shall have a Riverside County business street address. Post office box numbers, residential addresses or un-staffed sales offices shall not suffice to establish status as a "local business". To qualify as a "local business" the location must be open and staffed during normal business hours and the business must establish proof that it has been located and doing business in Riverside County for at least (6) six months preceding its certification to the County as a local business.

Additional supporting documentation that may be requested by the County to verify qualification includes:

1. **A copy of their current BOE 531-A and/or BOE 530-C form** (State, Local & District Sales and Use Tax Return Form). This is what businesses submit to the State Board of Equalization when paying the sales tax to the State of California indicating the amount of the payment to be credited to each jurisdiction (i.e. Counties, Cities).
2. **A current business license** if required for the political jurisdiction the business is located in.
3. **Proof of the current business address.** The local business needs to be operating from a functional office that is staffed with the company's employees, during normal business hours.

Business Name: _____

Physical Address: _____

Phone: _____ FAX: _____ E-Mail: _____

Length of time at this location: _____ Number of Company Employees at this address: _____

If less than 6 month, list previous Riverside County location: _____

Business License # (where applicable): _____ Jurisdiction _____

Hours of Operation: _____

Primary function of this location (i.e., sales, distribution, production, corporate, etc):

Signature of Company Official

Date

Submittal of false data will result in disqualification of local preference and/or doing business with Riverside County.

Form # 116-260 Rev 8/04

APN # 325-060-013

**AQMD ASBESTOS SURVEY
21665 Eucalyptus Lane, Perris
CV10-00386**

For:

County of Riverside Code Enforcement Department

By:

**County of Riverside Department of Public Health
Office of Industrial Hygiene**

Reference # 96770

January 6, 2011

Summary:

A total of two bulk building material samples were taken for analysis. No samples were found to contain one percent or greater asbestos. The result of the laboratory analysis can be found in the appendix. Sampling locations are illustrated in diagram 1.

See "CONCLUSION" for required actions by the owner and/or responsible party.

TITLE PAGE

Reference Number: 96770

Date of Report: January 6, 2011

Date of Field Evaluation: January 4, 2011

Individual Requesting Evaluation: Regina Keyes
Senior Code Enforcement Officer
Riverside County Code Enforcement
24318 Hemlock Avenue, Ste. C-1
Moreno Valley, CA 92557

Survey Site: 21665 Eucalyptus Lane, Perris CA
(One structure—Barn/Workshop)

Principal Investigator: Steven D. Hinde, REHS, CIH, CAC *SH*
Senior Industrial Hygienist
Department of Public Health
P.O. Box 7600
Riverside, California 92513-7600
(951) 358-5096
Certified Asbestos Consultant
DOSH # 94-1352

Written by: Steven D. Hinde, REHS, CIH
Senior Industrial Hygienist



TABLE OF CONTENTS

TOPIC	PAGE
PURPOSE OF SURVEY	1
SAMPLING METHODOLOGY	1
ANALYSIS	2
FINDINGS.....	2
Diagram 1: Illustrating overview of property and sample locations.....	3
Photograph 1: exterior of the structure	4
Photograph 2: interior of the structure	4
CONCLUSION	5
APPENDICES	
A: Laboratory Report	

Purpose of Survey:

To evaluate the possible sources of asbestos containing building materials (ACBM) in the accessible areas of the above mentioned structure and property in accordance with AQMD rule 1403, prior to renovation or demolition of building structures.

Sampling Methodology:

Quantity of Samples:

For friable materials the provisions of 40 CFR 763.107 are followed (minimum of 3 samples for suspected friable building materials).

For nonfriable materials [Tile, roofing products, vinyl floor coverings, transite sheetings and pipes (may be assumed to be ACBM), sheet rock, stucco, etc.] sufficient number of samples based on Industrial Hygienist experience and judgement shall be taken to determine presence of asbestos. Frequently, one sample may be sufficient for each building material type. If nonfriable floor tile contains no asbestos, then mastic will not be analyzed unless project requires partial demolition.

Gathering Suspected Asbestos-Containing Material:

First, the suspected material is wetted with water to minimize possible fiber release. Tools are then used to free the suspect material from its substrate. The material is then placed in its own sample bag and labeled with a unique number ("Client's Sample Number"). The samples are then transported to the lab for analysis.

Analysis:

Asbestos bulk analysis using dispersion staining and polarized light microscopy. The methodology used is EPA 600/ R-93/116.

QuanTEM at 2033 Heritage Drive, Oklahoma City, OK is a National Voluntary Laboratory Accreditation Program (NVLAP) accredited laboratory (Lab code 101959). Phone # (405) 755-7272.

Findings:

Diagram 1 illustrates overview of property and sample locations.

Photograph 1 shows the exterior of barn/workshop.

Photograph 2 shows the interior of the one of the walls of the barn/workshop. A sample was taken from this location.

Diagram 1: Sampling Points

This diagram illustrates the locations of samples taken at 21665 Eucalyptus Lane, Perris. An "x" denotes each sampling point. The client's sample number (for reference to the lab report in the appendix) may be obtained by attaching the prefix "770-EL- " to each location number.

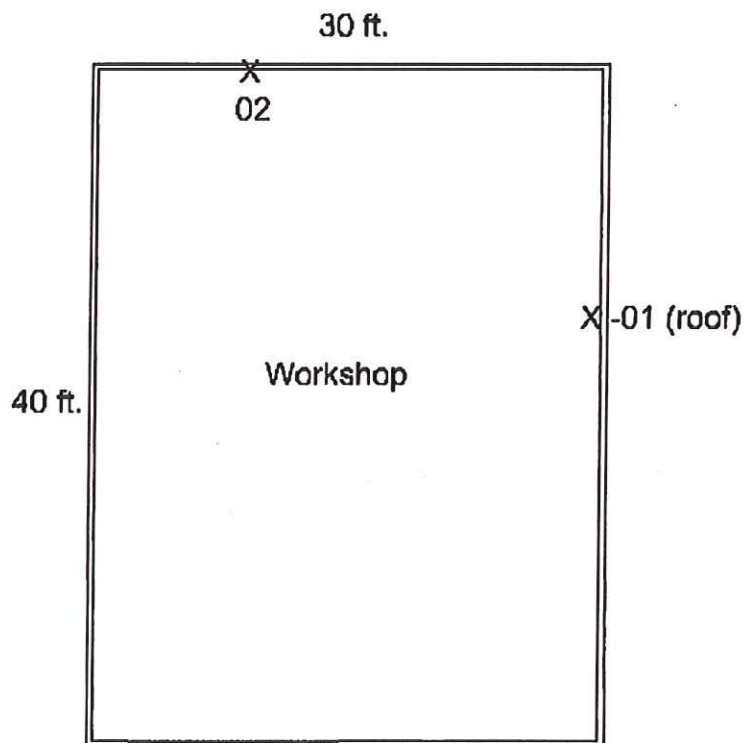



Photograph 1- illustrates the front exterior of the barn/workshop at 21665 Eucalyptus Lane, Perris.



Photograph 2- illustrates the interior from rear wall in the barn/workshop at 21665 Eucalyptus Lane, Perris.

**Discussion Concerning
Inaccessible Areas:**

An inspection was made of all accessible areas on the site. Based on the material present at the site, it is unlikely that additional asbestos containing material may be found.

An area is considered accessible if it can be fully explored. If the inspector feels it is unsafe to enter an area, or if size considerations restrict entry, the area is considered inaccessible. Speculations on whether an area might contain asbestos are based on the inspector's knowledge and experience.

CONCLUSION:

Asbestos containing building materials are not present at the site surveyed.

1. Have your demolition contractor fill out an AQMD form completely. (You must maintain a copy of this survey report and notification for three years - Rule 1403 (g) Recordkeeping -).

If, during the course of demolition, additional ACBM is identified (e.g., discovered in inaccessible areas) demolition must cease. The ACBM must be kept wet. Demolition activities may continue only after an asbestos abatement contractor has removed the ACBM.



2033 Heritage Park Drive / Oklahoma City, OK 73120 / (405) 755-7272 / Fax (405) 755-2058

**County of Riverside
Dept. of Health-Industrial Hygiene.
4065 County Circle
Riverside, CA 92503**

Re: QuantEM ID 190800

QuantEM appreciates the opportunity to provide analytical testing services to you. Attached are your reports and other supporting documentation for the above referenced project.

Thank you for making QuantEM your lab of choice. If you have any question concerning this or other reports please feel free to contact us at 800-822-1650.

We continually work to improve our service. Help us out by providing feed back on your experience at www.QuanTEM.com. Click on Service Survey and fill out the form. We look forward to hearing from you.

Respectfully,
QuantEM Laboratories, LLC.





2033 Heritage Park Drive / Oklahoma City, OK 73120 / (405) 755-7272 / Fax (405) 755-2058

Polarized Light Microscopy Asbestos Analysis Report

QuantEM Lab No. 190800
 Account Number: A374
 Date Received: 01/05/2011
 Received By: Sherrie Leftwich
 Date Analyzed: 01/06/2011
 Analyzed By: Stacey Holder
 Methodology: EPA/600/R-93/116

Client: County of Riverside
 Dept. of Health-Industrial Hygiene.
 4065 County Circle
 Riverside, CA 92503
 Project: AQMD Survey
 Project Location: 21665 Eucalyptus Lane, Perris, CA
 Project Number: 96770

QuantEM Sample ID	Client Sample ID	Composition	Color / Description	Asbestos (%)	Non-Asbestos Fiber (%)	Non Fibrous
001	770-EL-01	Homogeneous	Blue Shingle	Asbestos Not Present	Cellulose 2 Glass Fiber 15	Tar Sand
002	770-EL-02	Layered	White Texture	Asbestos Not Present	Cellulose 2	CaCO3
002a		Layered	White Sheetrock	Asbestos Not Present	Cellulose 45	Gypsum

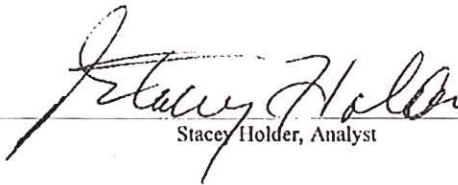
 Stacey Holder, Analyst

1/6/2011
 Date of Report

Unless otherwise noted, upon receipt the condition of the sample was acceptable for analysis.

QuantEM is a NVLAP accredited TEM and PLM laboratory (Lab Code: 101959-0). This report relates only to the specific items tested. NVLAP accreditation applies only to analysis performed utilizing EPA/600/M4-82-020 and EPA/600/R-93/116 methods. This report may not be used to claim product endorsement by NVLAP or any other agency of the US Government. This report may not be reproduced except in full, without the written approval of the laboratory.



www.QuanTEM.com

ASBESTOS CHAIN OF CUSTODY

2033 Heritage Park Drive, Oklahoma City, OK 73120-7502
(800) 822-1650 • (405) 755-7272 • Fax: (405) 755-2058

LEGAL DOCUMENT - PLEASE PRINT LEGIBLY

Lab No. 140800 Accept Reject

QuantEM Website Other

Project Name: AQMD Survey

Project Location: 21665 Eucalyptus Lane, Perris, CA

Project ID: 96770

Company: Riverside County Public Health

Contact: Steven Hinde

Account #: A374

Phone: (951) 358-5096

Cell Phone:

E-mail: shinde@rivcocha.org

Name: Steven Hinde

Date: 1/4/11

1/4/11 2:05 FedEx Shepherd 11/11 9:10

Sample ID	Sample Location	Sample Type	Analysis Method	Analysis Results	Comments
<input checked="" type="checkbox"/>	Bulk Analysis (EPA 600/R-93/116)	<input type="checkbox"/> Vermiculite Attic Insulation (EPA 600/R-04/004)	<input type="checkbox"/> Air-AHERA	<input type="checkbox"/> Bulk - Presence / Absence EPA600/R-93/116	<input type="checkbox"/> Rush
<input type="checkbox"/>	400 Point Count	<input type="checkbox"/> Other	<input type="checkbox"/> Air-NIOSH 7402	<input type="checkbox"/> Bulk-Quantitative (weight-%)- Chatfield	<input type="checkbox"/> Same Day
<input type="checkbox"/>	1000 Point Count		<input type="checkbox"/> Air-ISO 10312	<input type="checkbox"/> Dust- Presence / Absence	<input checked="" type="checkbox"/> 24 - Hour
<input type="checkbox"/>	Gravimetric Preparation		<input type="checkbox"/> Drinking Water- EPA 100.2	<input type="checkbox"/> Dust- Quantitative (fibers/sq.cm)- ASTM D5755	<input type="checkbox"/> 3 - Day
<input type="checkbox"/>	Particle ID	<input type="checkbox"/> NIOSH 7400	<input type="checkbox"/> Waste Water- EPA 600/4-83-043	<input type="checkbox"/> Other	<input type="checkbox"/> 5 - Day

Sample ID	Sample Location	Sample Type	Analysis Method	Analysis Results	Comments
1	770-EL-01	White/Black	Roofing	Roof	Barn/Workshop
2	770-EL-02	White	Drywall	Inside Wall	Barn/Workshop
3					
4					
5					
6					
7					
8					
9					
10					

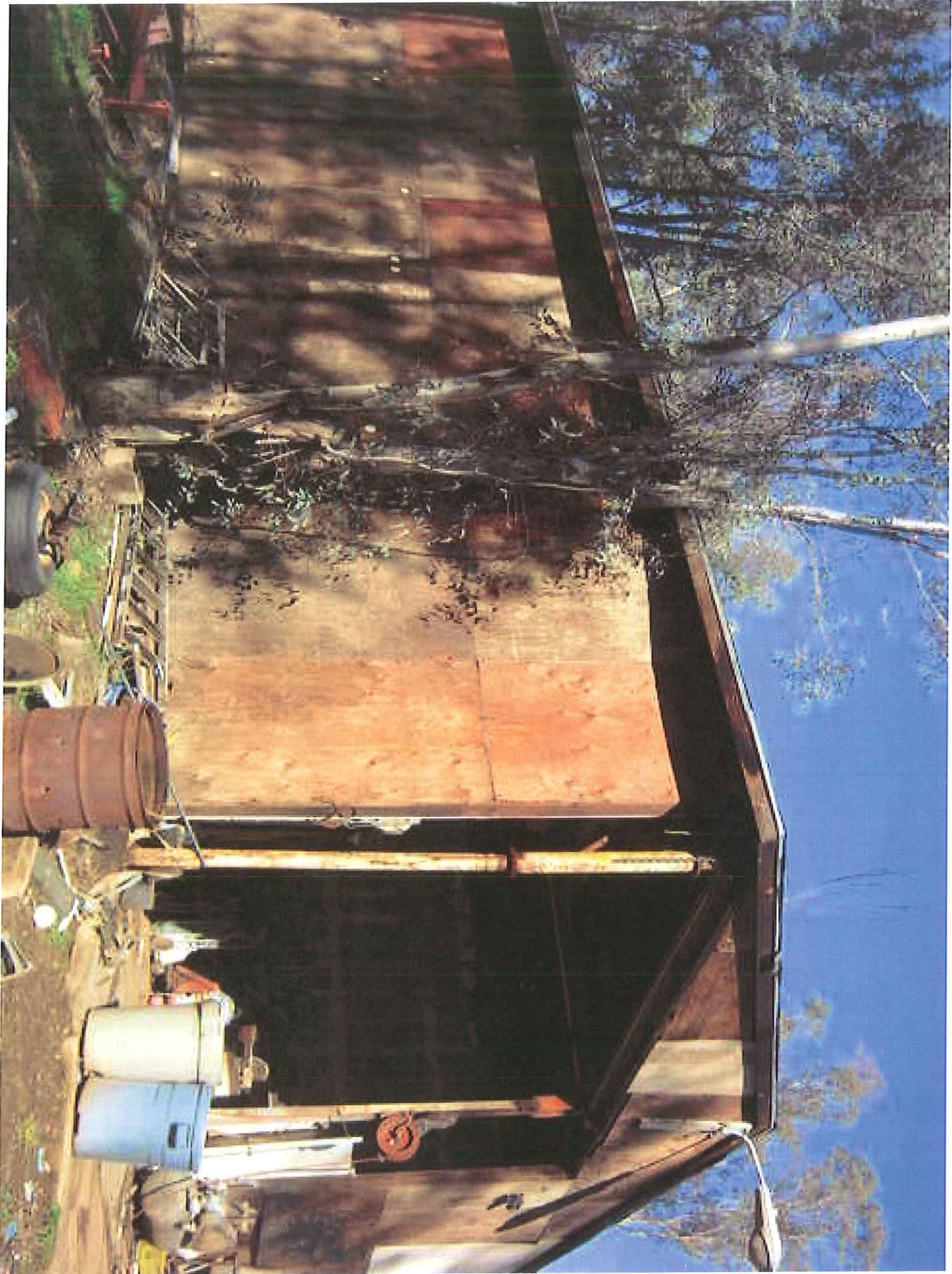

807

SEE 777 MAP

SEE 777 MAP

SEE 777 MAP

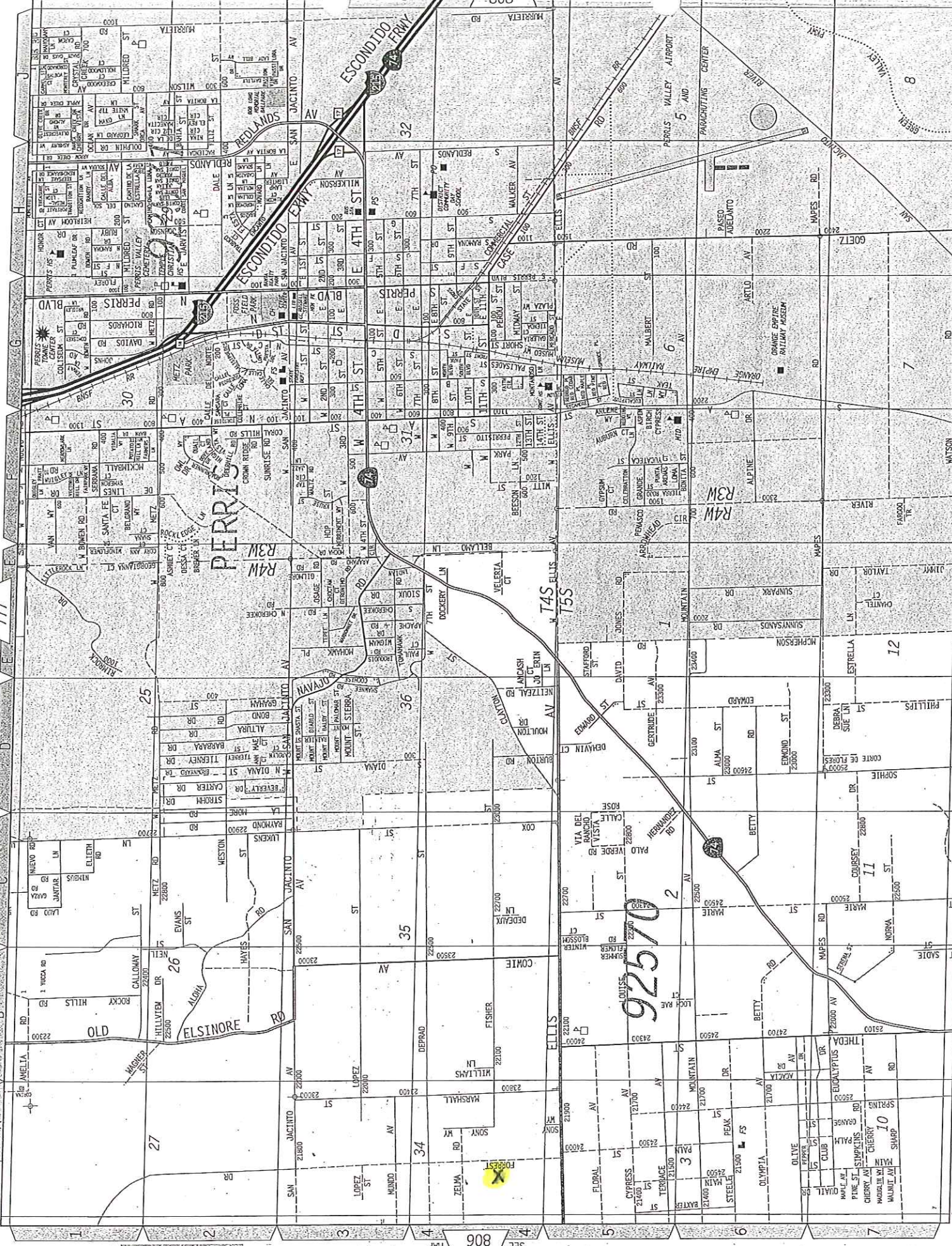

RIVERSIDE COUNTY GIS



Selected parcel(s):
325-060-013

IMPORTANT

Maps and data are to be used for reference purposes only. Map features are approximate, and are not necessarily accurate to surveying or engineering standards. The County of Riverside makes no warranty or guarantee as to the content (the source is often third party), accuracy, timeliness, or completeness of any of the data provided, and assumes no legal responsibility for the information contained on this map. Any use of this product with respect to accuracy and precision shall be the sole responsibility of the user.

REPORT PRINTED ON...Tue Feb 01 14:07:11 2011

Version 101221